

**WALK IN CLOSET**



# WALK IN CLOSET



Fix the first vertical profile to the wall.

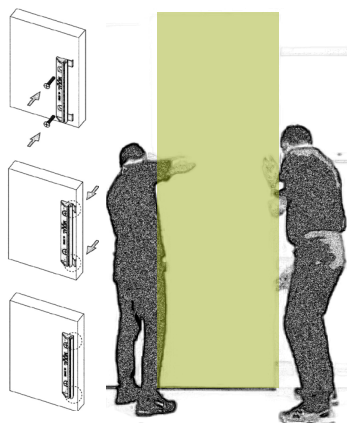

Put clip on the first panel and attach to the panel the second vertical profile.

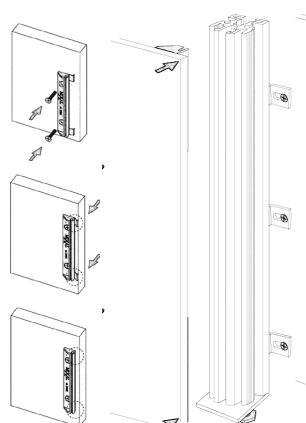

Clip the panel to the first profile, and fix the second profile to the wall.



Repeat the operation for all the panels of your walk in closet application.

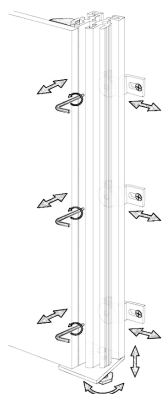

Once all the panels are fixed proceed with the front and height adjustments.

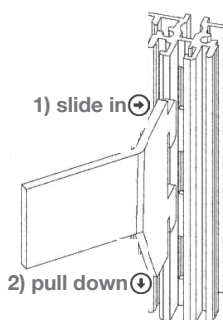

1) slide in ➔

2) pull down ⬇

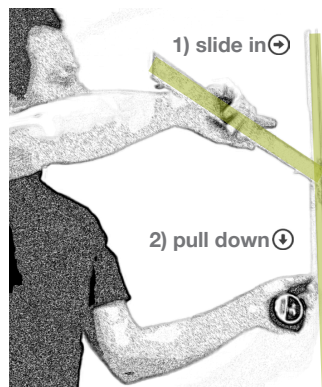

1) slide in ➔

2) pull down ⬇

Install the shelves and the cabinets. Slide the shelf support in the hole of the vertical profile. Pull down the shelf support for fix with the vertical profile.

## VERTICAL ALUMINIUM RACK PROFILE WITH 4MM GAP

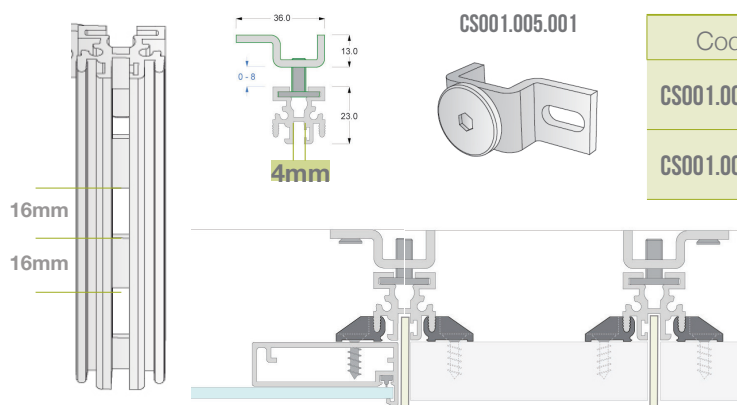

Code	Description	Length (mm)	Box
<b>CS001.001.001</b>	Aluminium vertical profile for single shelf	2650	50
<b>CS001.005.001</b>	Metal wall fixing clip with adjustment	-	200

## VERTICAL ALUMINIUM RACK PROFILE WITH 9MM GAP

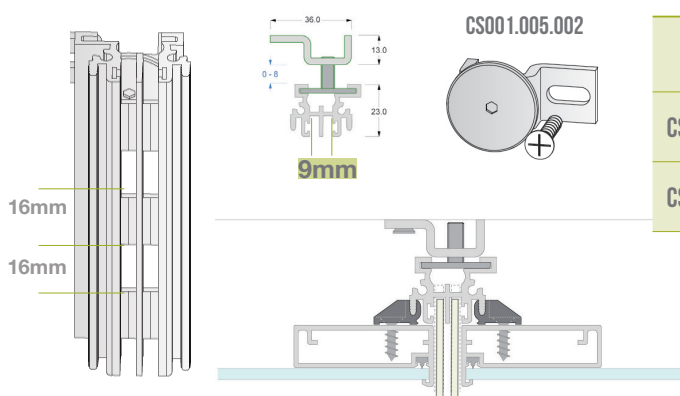

Code	Description	Length (mm)	Box
<b>CS001.001.002</b>	Aluminium vertical profile for double shelf	2650	50
<b>CS001.005.002</b>	Metal wall fixing clip with adjustment	-	200

## PLASTIC CLIP FOR PANEL

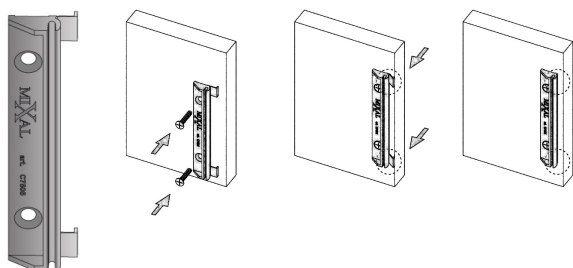

Code	Description	Length (mm)	Box
<b>CS001.004.001</b>	Plastic clip for screw fixing to the panel	-	200

## CONNECTOR AND SHELF BRACKET FOR CORNER UNIT

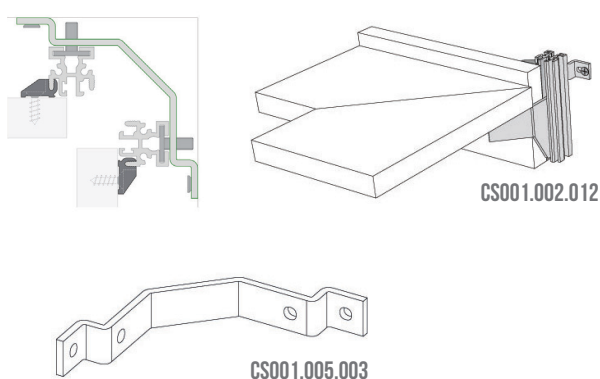

Code	Description	Length (mm)	Box
<b>CS001.005.003</b>	Metal fixing plate for corner units	-	50
<b>CS001.002.012</b>	Shelf support for corner application	60	50

# SHELF BRACKETS FOR SHELF SUPPORT INT. 15MM

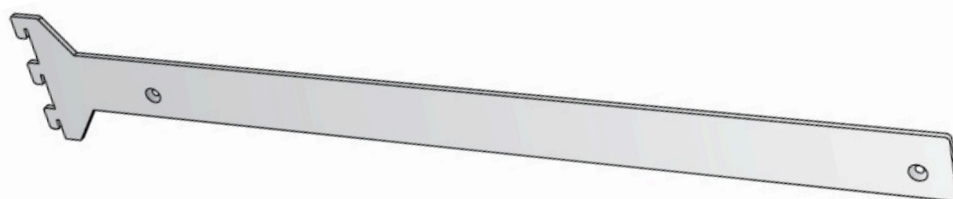

Possible to produce in customized measure

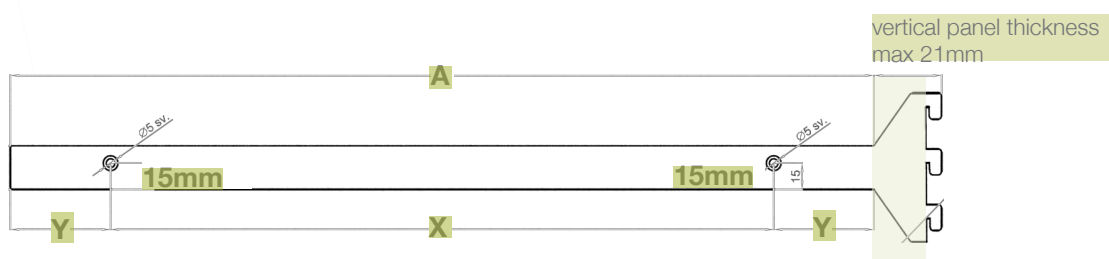

Code	Shelf Thick (mm)	A (mm)	Int (mm)	X (mm)	Y (mm)	Finishing	Box
CS001.002.025	25	500	15	384	58	Grey	50
CS001.002.036	25	450	15	384	33	Grey	50
CS001.002.038	25	400	15	352	24	Grey	50

## SHELF SUPPORT INT. 15MM

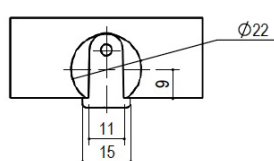
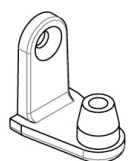

Code	Shelf Thick (mm)	Finishing	Box
JB089.003.003	25	Nickel Plated	2000

### Single shelf application

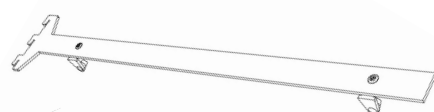

Screws and nuts are not supplied with shelf support.  
Suggested to use screw M4x8 for single application and M4x12 for double application.

### Double shelf application

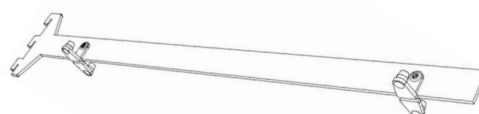

# SHELF BRACKETS FOR STANDARD SHELF SUPPORT

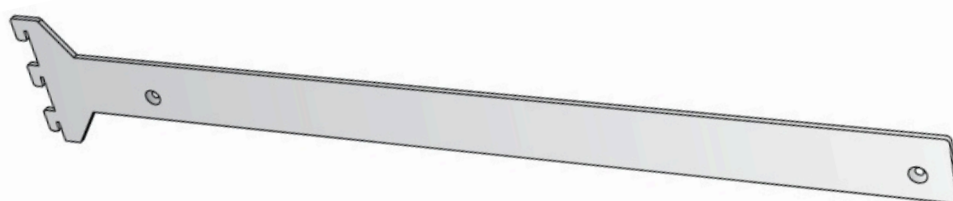

Possible to produce in customized measure

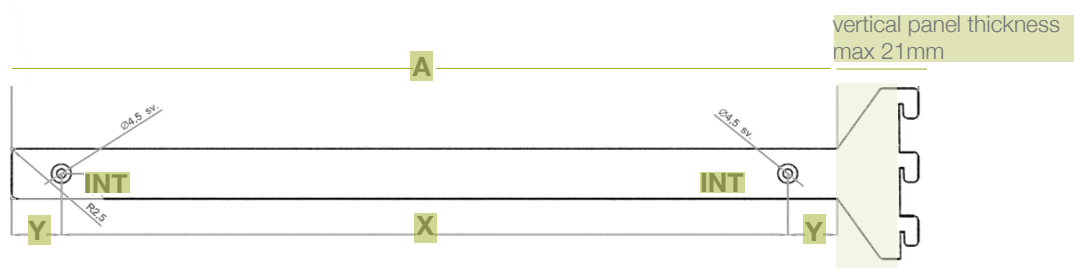

Code	Shelf Thick (mm)	A (mm)	Int (mm)	X (mm)	Y (mm)	Finishing	Box
CS001.002.037	25	500	12,5	384	58	Grey	50
CS001.002.031	18	500	9	384	58	Grey	50
CS001.002.011	25	400	12,5	352	24	Grey	50
CS001.002.008	18	400	9	352	24	Grey	50
CS001.002.032	25	300	12,5	256	22	Grey	50
CS001.002.033	18	300	9	256	22	Grey	50

## SUGGESTION OF SHELF SUPPORT APPLICATION

### Single shelf application



### Double shelf application

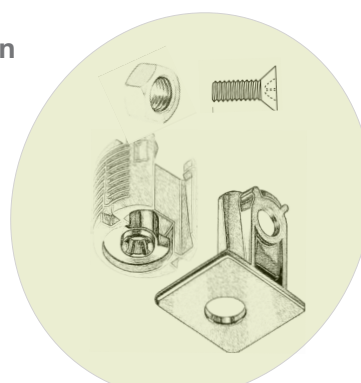
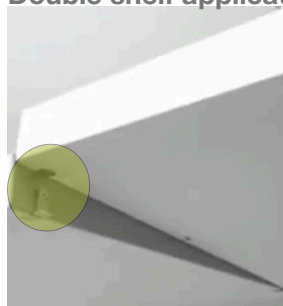

Small shelf supports are not supplied with shelf brackets. These pictures are for exemplification purpose only. Every customer can use own model of shelf support.

# SHELF BRACKETS WITH LUG

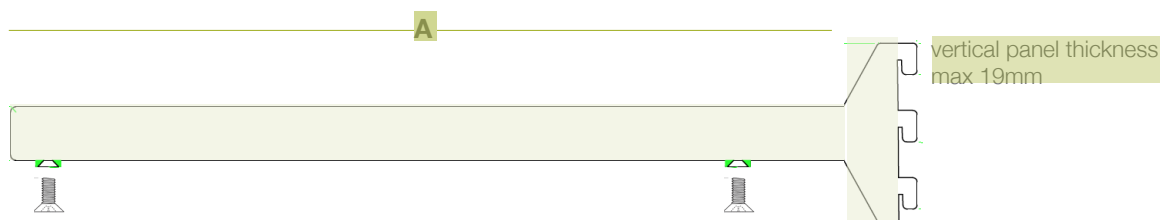

## LEFT SHELF BRACKETS WITH LUG

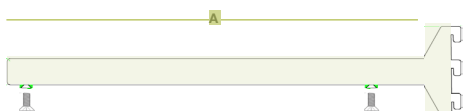

Code	Type	A (mm)	Panel Thick (mm)	Finishing	Box
CS001.002.017	left	400	25	Grey	50
CS001.002.018	left	300	25	Grey	50
CS001.002.020	left	400	18	Grey	50
CS001.002.019	left	300	18	Grey	50

## RIGHT SHELF BRACKETS WITH LUG

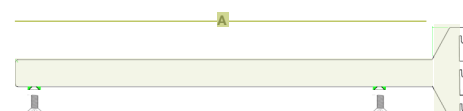

Code	Type	A (mm)	Panel Thick (mm)	Finishing	Box
CS001.002.013	right	400	25	Grey	50
CS001.002.015	right	300	25	Grey	50
CS001.002.016	right	400	18	Grey	50
CS001.002.014	right	300	18	Grey	50

## CENTRAL SHELF BRACKETS WITH LUG

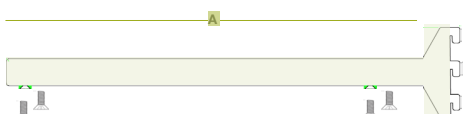

Code	Type	A (mm)	Panel Thick (mm)	Finishing	Box
CS001.002.021	central	400	25	Grey	50
CS001.002.024	central	300	25	Grey	50
CS001.002.022	central	400	18	Grey	50
CS001.002.023	central	300	18	Grey	50

# CABINET BRACKETS

Code	Type	Height (mm)	Finishing	Box
CS001.003.004	Right	54	Grey	50
CS001.003.005	Left	54	Grey	50

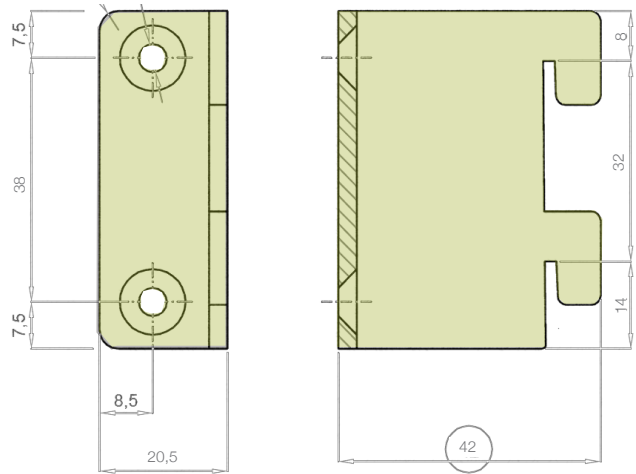

## CABINET BRACKET LENGTH 500MM

Code	Length (mm)	Height (mm)	Finishing	Box
CS001.003.003	500	96	Grey	50

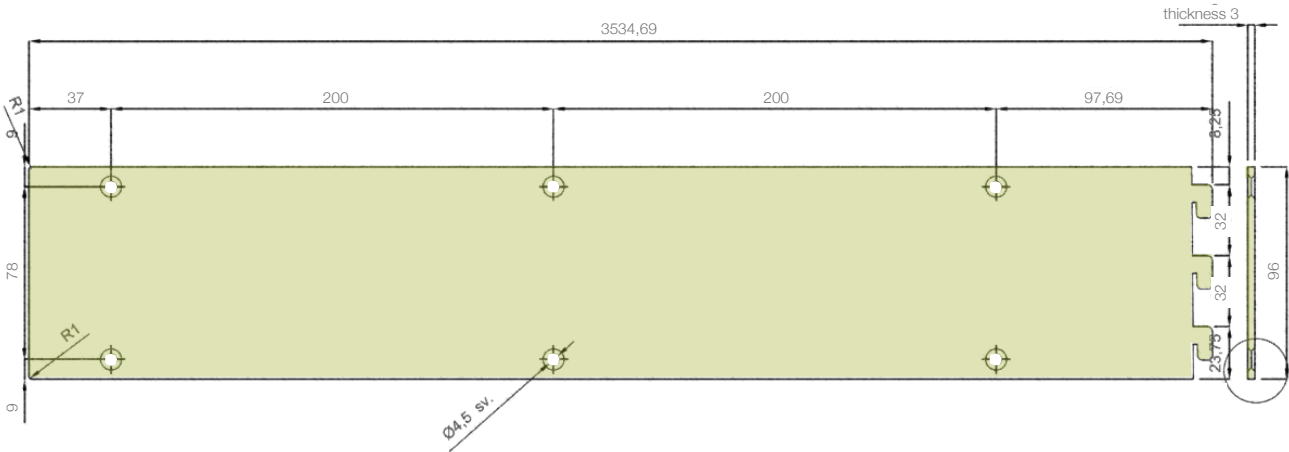
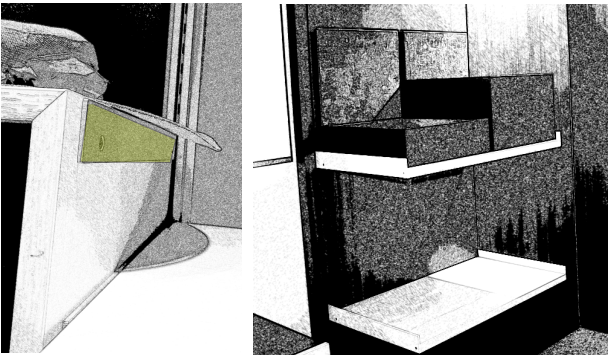



SQUARE CABINET BRACKET

Code	(mm)	Finishing	Box
CS001.003.007	192X192	Grey	50

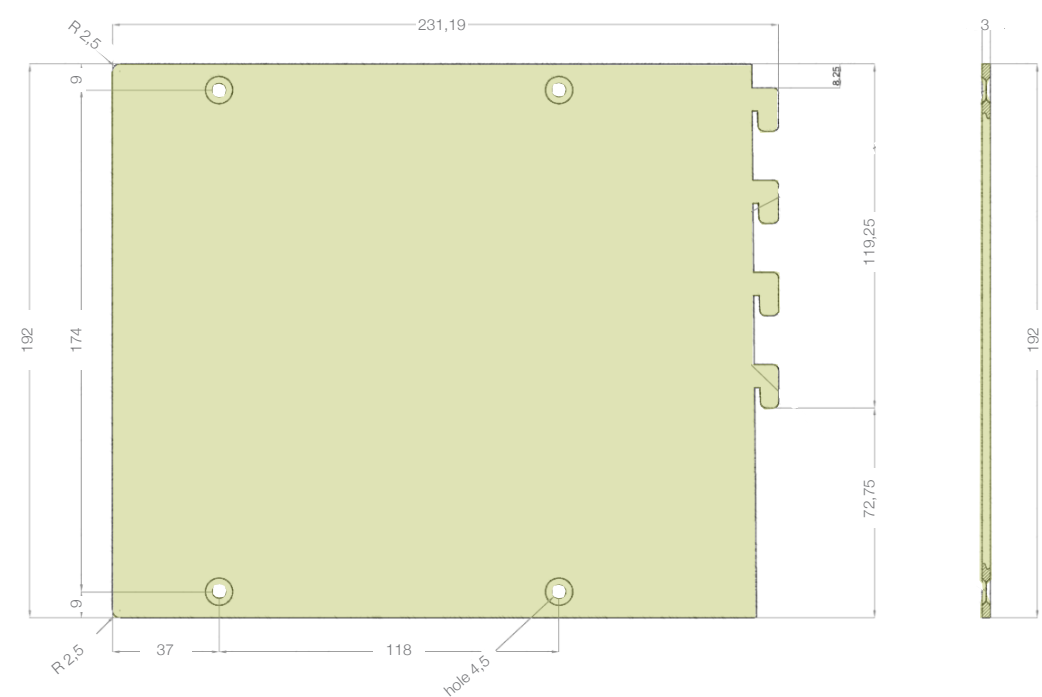

ALUMINIUM CARTER PROFILE

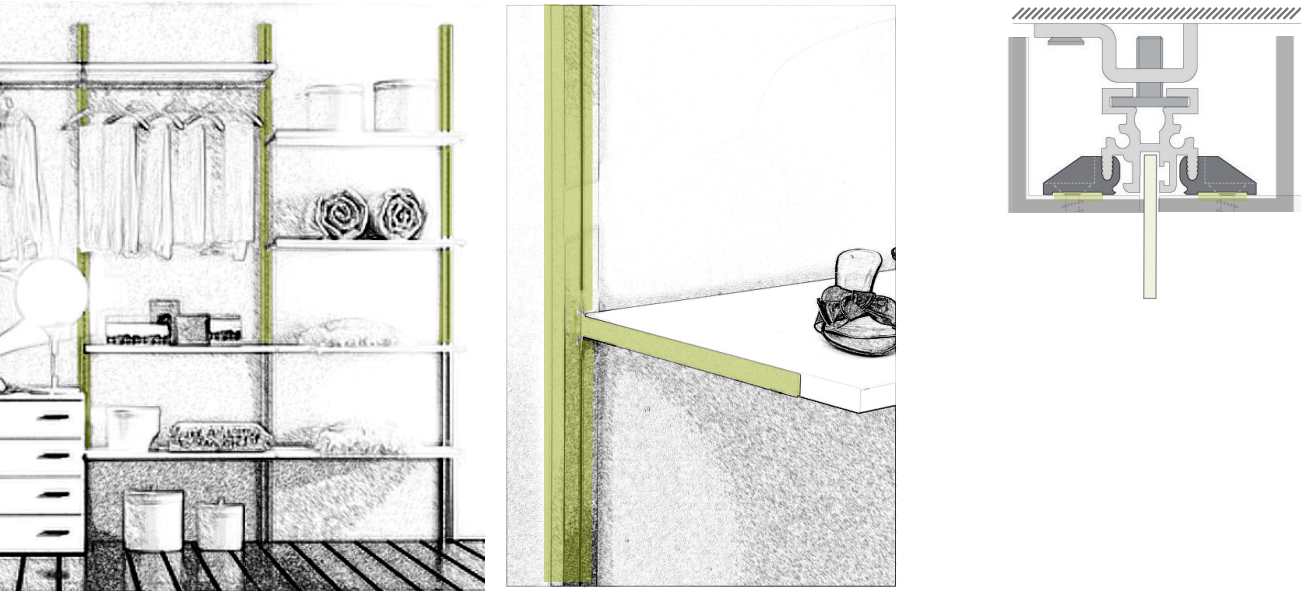

Code	Length (mm)	Finishing	Box
CS001.007.001	2650	Anodized Aluminium	50



WITH VHB SELF  
ADHESIVE

Code	Finishing	Box
CS001.004.002	Black Plastic	200





Code	Type	Height (mm)	Finishing	Box
<b>CS001.008.002</b>	Right	309	Grey	50
<b>CS001.008.001</b>	Left	309	Grey	50



Code	Length (mm)	Load C.	Finishing	Box
<b>WA062.002.001</b>	750-1150	10kg	Grey	6
<b>WA062.002.002</b>	500 - 750	10kg	Grey	6

