



**INTEGRATO**

# INTEGRATO

**INTEGRATO** is the new leveller suitable to align heavy duty wardrobes, bookcases and modular furniture.

The leveller is installed and safely fixed onto the bottom of the carcass through a wide range of supports complete with pins and screw holes, spikes and screw holes or again screw holes only.

A further securement in position can be obtained by a countersunk 4x18mm length screw from underneath first and also 2 panhead 3,5x15mm length screws from the side secondly if required.

A Ø8mm through hole in the furniture bottom, allows to adjust the leveller from the above, by using a S6mm allen wrench or both cross and blade screwdriver.

The zinc alloy die-cast foot, is provided with an independent engineering plastic glide in order to make the adjustment easier and to prevent the scratching of the floor too.

Over the leveller can be slotted a spacer to give a structural support to the furniture bottom. The spacer is available in three heights (see the related page).

Capable of supporting a 175kg load each.

12mm adjustment

25mm adjustment

Tested according to CATAS Institute requirements.

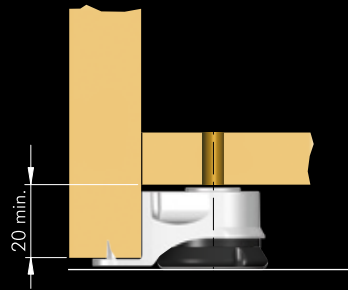

Adjustment 0÷12

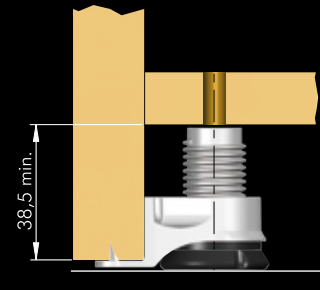

Adjustment 0÷25

## APPLICATION

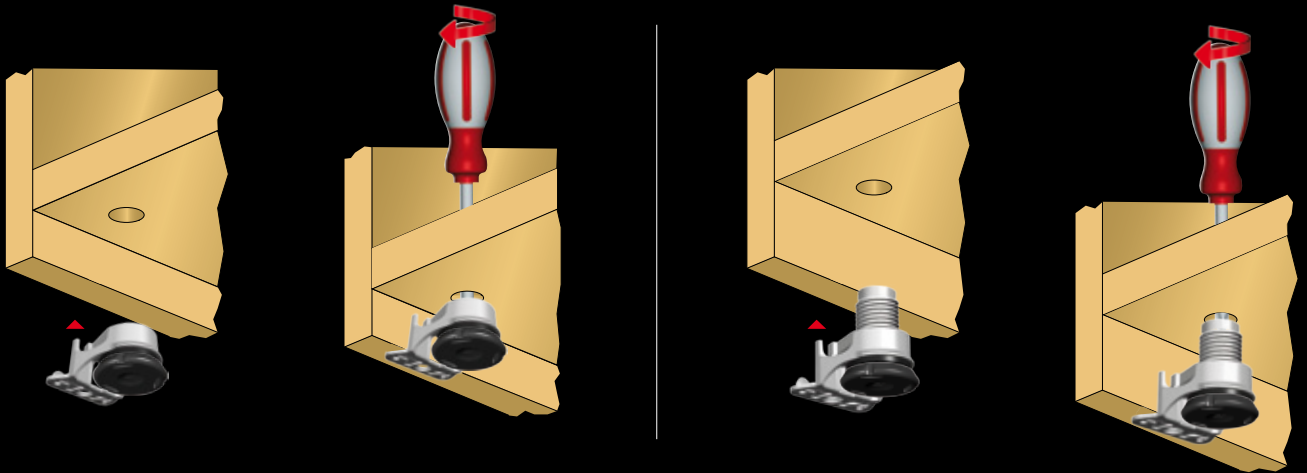

## DETAILS

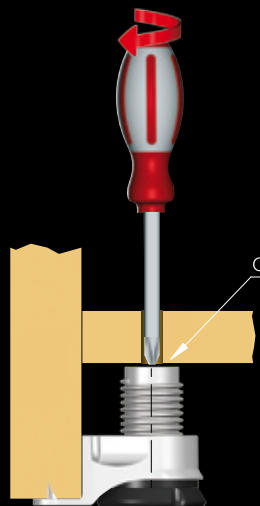

Combi slot for S6mm allen wrench and both cross and blade screwdriver.



## INTEGRATO A

Part. no	Adjustment
3010101000	12mm
3010102000	25mm

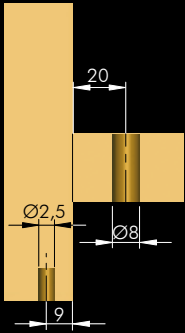
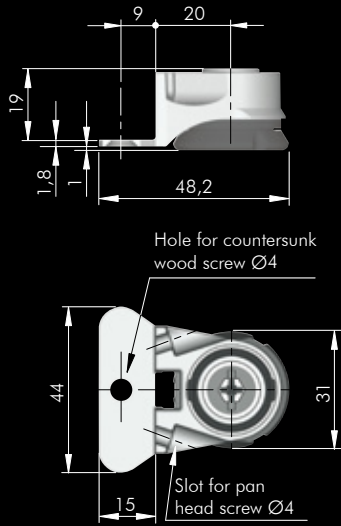

## INTEGRATO B

Part. no	Adjustment
3010201000	12mm
3010202000	25mm

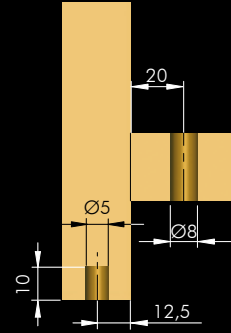
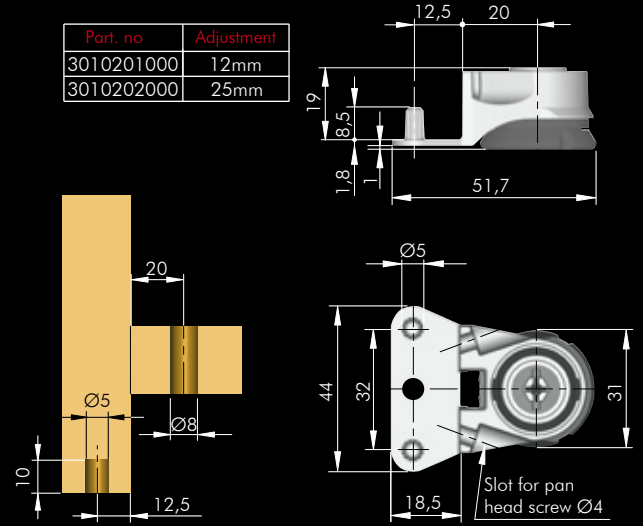

## INTEGRATO C

Part. no	Adjustment
3010301000	12mm
3010302000	25mm

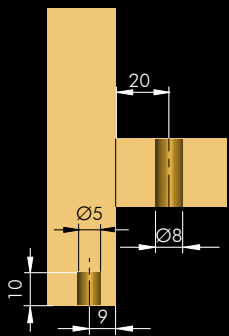
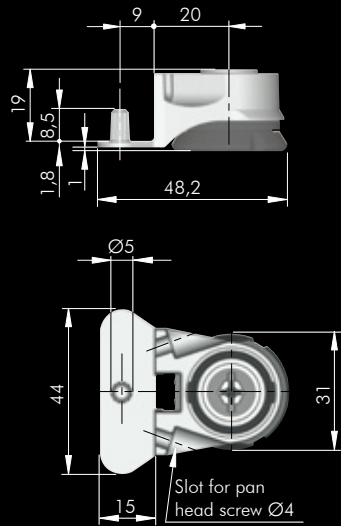

## INTEGRATO D

Part. no	Adjustment
3010401000	12mm
3010402000	25mm

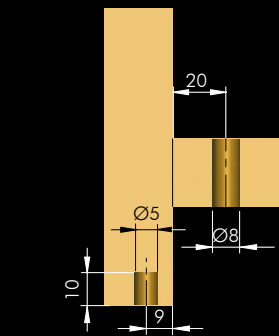
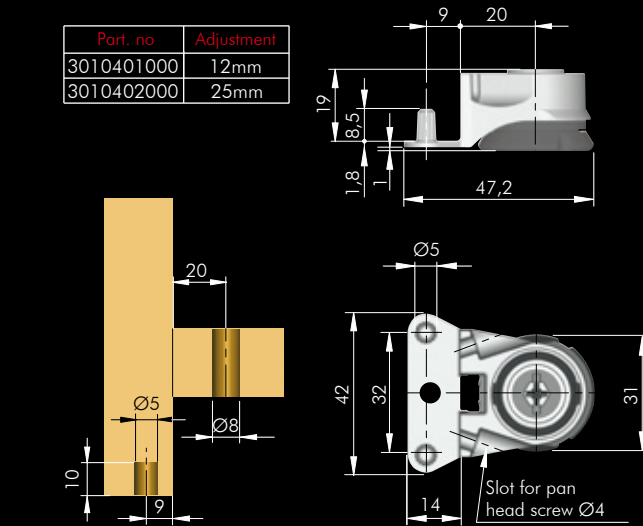

## INTEGRATO E

Part. no	Adjustment
3010501000	12mm
3010502000	25mm

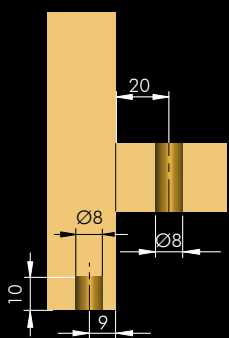
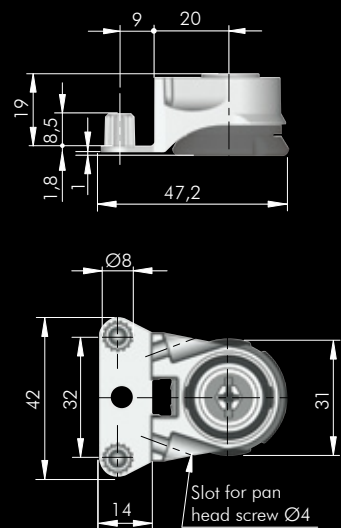

## INTEGRATO G

Part. no	Adjustment
3010601000	12mm
3010602000	25mm

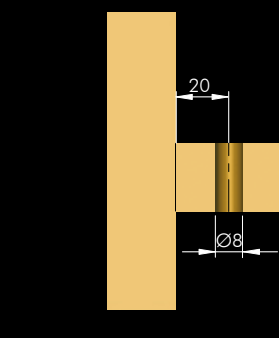
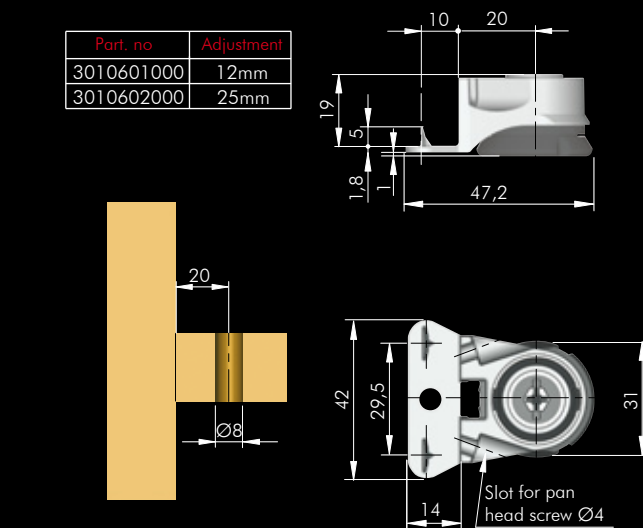

# SPACER

Whenever it is deemed necessary, over the leveller INTEGRATO, can be slotted a **SPACER** to give a structural support to the furniture bottom.

The spacer is available in four heights ( H=24, H=34, H=40, H=60)

Engineering plastic



## SPACER H24

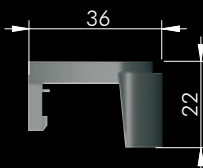
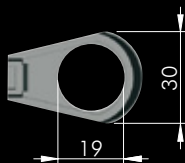
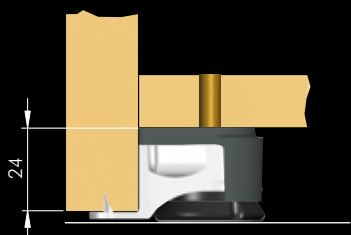

Part no.  
30107010EA

## SPACER H34

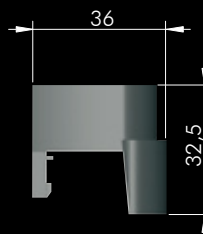
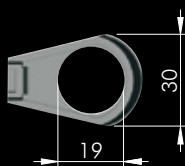
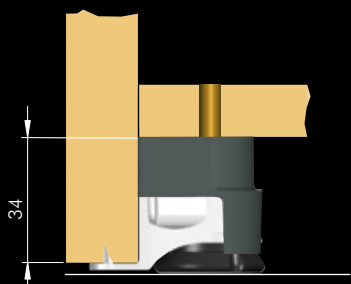

Part no.  
30107040EA

## SPACER H40

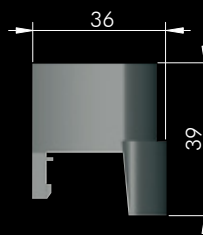
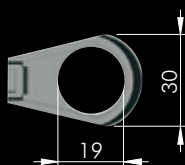
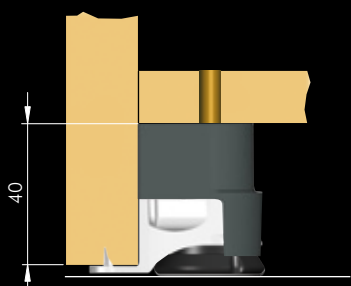

Part no.  
30107020EA

## SPACER H60

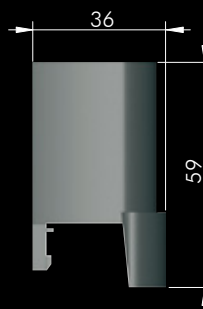
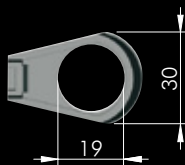
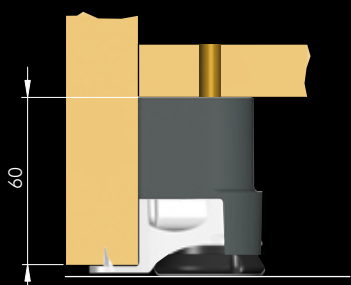

Part no.  
30107030EA

## APPLICATION

