

TRIADE





**TRIAD** is the concealed mounting bracket for shelves 25 to 40mm thick. It has been conceived to simplify the shelf installation. It is provided with three independent adjustments:

**1) VERTICAL**

Before installing the shelf, the mounting brackets can be adjusted in height and (vertically) aligned through the slots.

**2) HORIZONTAL**

While placing the shelf in position, the supporting pins can be slid horizontally.

**3) INCLINATION**

When the shelf is partially inserted, the shelf angle can be adjusted front to back by turning the supporting pins with a 10mm open-ended wrench.

The capacity loading is 15Kg each (shelf weight included) for a shelf max 300mm deep.

Shelf minimum depth: 160mm

Zinc alloy and steel

PAT. PENDING

Part. no
1621501000

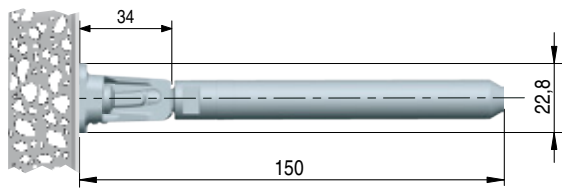

For shelf 25-30mm thick

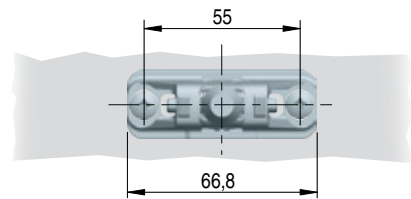
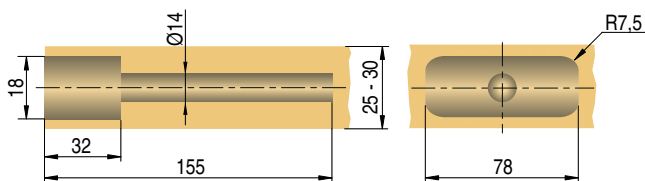

For shelf 30mm thick and above

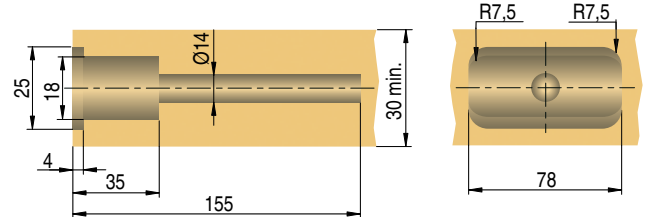

## FIXING TO CEMENT WALL

**VERY IMPORTANT**

Triade has to be installed with the writing "TOP - ALTO" facing upwards.

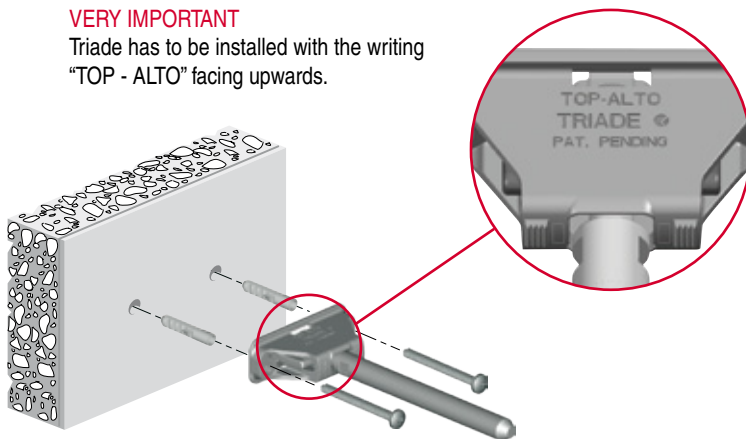

**Fixing:**

- to cement wall with rawlplugs Ø 8mm & pan head screws Ø 5x50mm.
- to wood panels with pan head wood screws Ø 5mm.
- to plaster boards with umbrella fittings Ø 8mm & pan head screws M4x46mm.

It is the responsibility of the customer:

- to ensure the wall is of a suitable quality to hold the shelf fixing in place.
- to use the proper hardware fittings according to the construction of the wall.

## COMBINATION SHELF LOAD AND SHELF DEPTH (The figures refer to 1 shelf support)

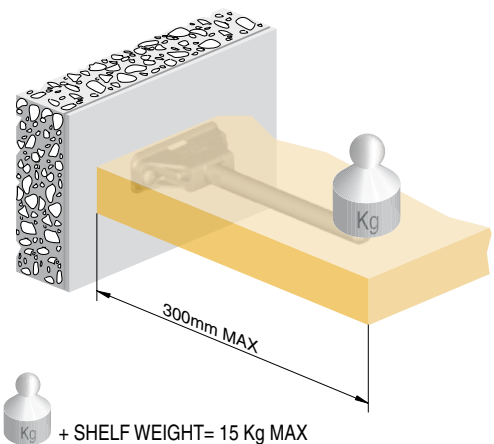
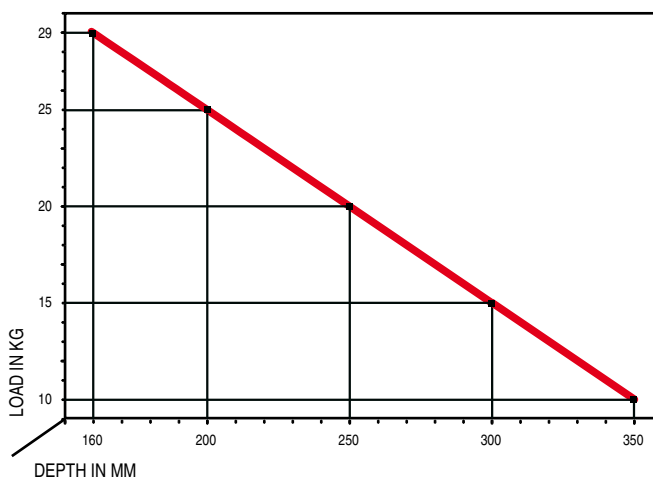

Kg + SHELF WEIGHT= 15 Kg MAX

**BRACKET FOR TRIADE** with pin is a valid complement to the concealed shelf support TRIADE. Ideal to improve the shelf support capacity loading by evenly distributing the shelf load on the wall through a Ø 8mm pin.

The Ø 8mm pin allows to reduce the load taken by the two fixing screws.

Part. no	Description	Finish
16215020ZN	Bracket for TRIADE	Zinc-plated
60334030ZN	pan head screw M5x12mm	Zinc-plated

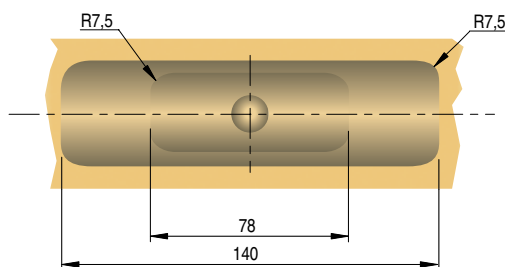
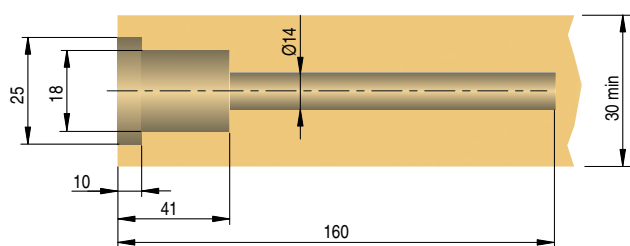
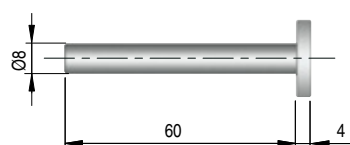
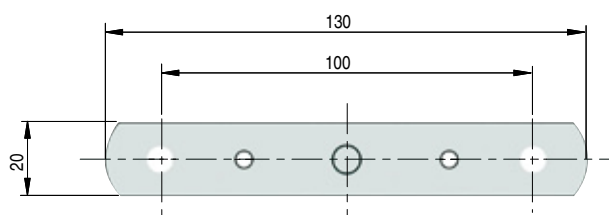

## FIXING TO WALL

Fixing the TRIADE onto the bracket with pan head screws M5x12mm.

Fixing the assembled TRIADE & bracket:

- to cement wall with rawplugs Ø 8mm & pan head screws Ø 5x50mm.
- to wood panel with 2 pan head wood screws Ø 5mm.
- to plaster board with umbrella fittings Ø 8mm & pan head screws M4x16mm.

It is the responsibility of the customer:

- to ensure the wall is of a suitable quality to hold both the inserting of the bracket with pin and the TRIADE in place.

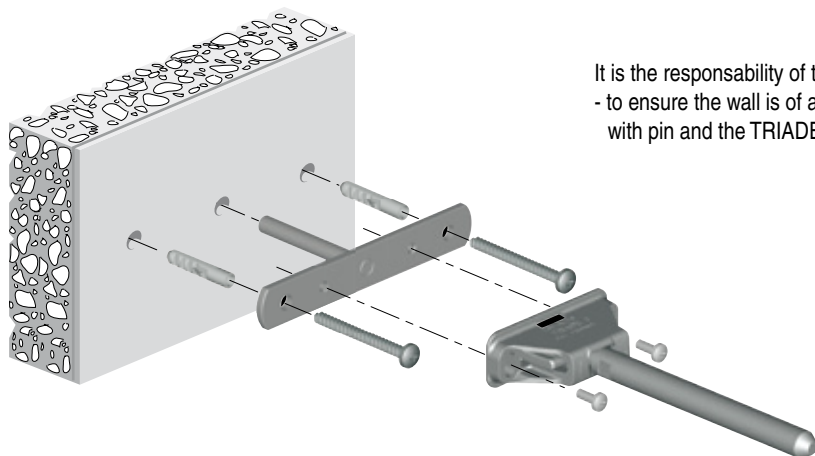

## VERTICAL ADJUSTMENT

RELEASE THE FIXING SCREWS

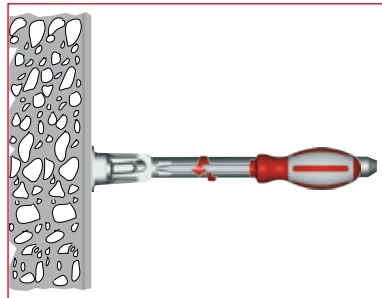

ALIGN BRACKETS VERTICALLY ACCORDINGLY

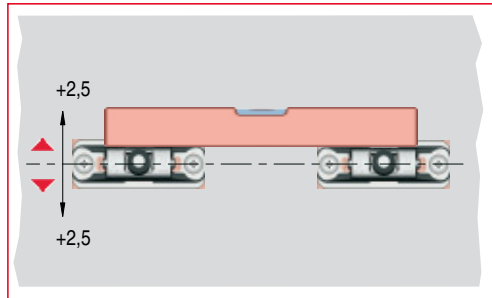

TIGHT THE FIXING SCREWS

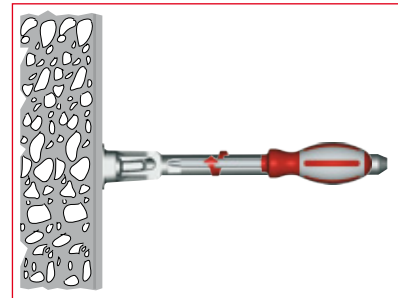

## SHELF INSERTING AND HORIZONTAL ADJUSTMENT

TILT THE SHELF TO MATCH BOTH SUPPORTING PINS AND SHELF HOUSINGS

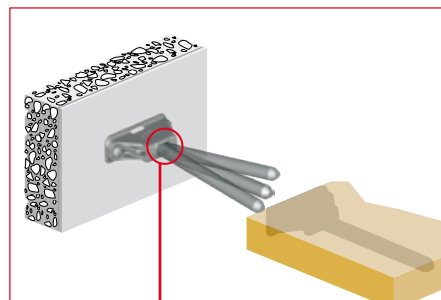

INSERT PARTIALLY THE SHELF

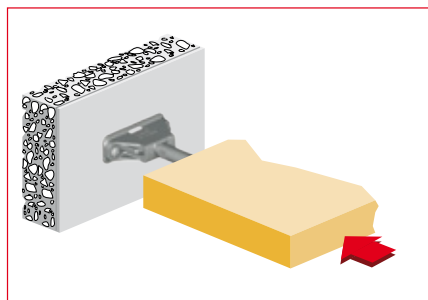

ADJUST THE SHELF HORIZONTALLY ACCORDING TO THE APPLICATION (i.e. MULTI-SHELF COMPOSITION)

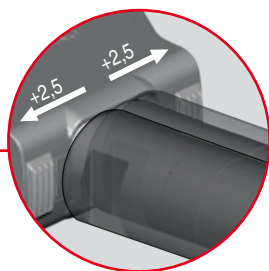
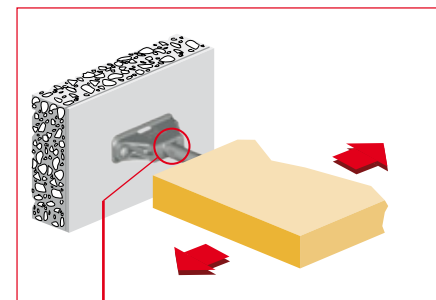

## INCLINATION ADJUSTMENT

TURN CLOCKWISE THE SUPPORTING PIN WITH A 12mm OPEN-ENDED WRENCH TO ADJUST THE SHELF ANGLE FRONT TO BACK ACCORDINGLY

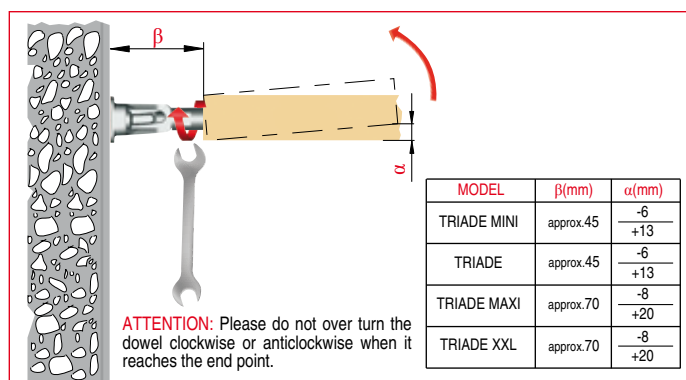

SCREW THE LOCKING BOLT TO BLOCK THE PIN

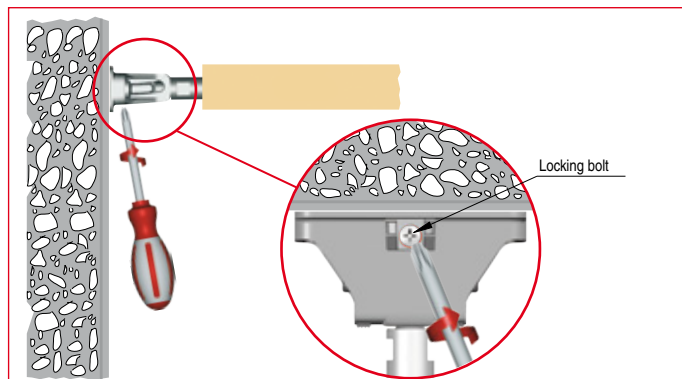

## SHELF INSERTING FOR ALL TRIADE MODELS

PUSH THE SHELF AGAINST THE WALL UNTIL THE END

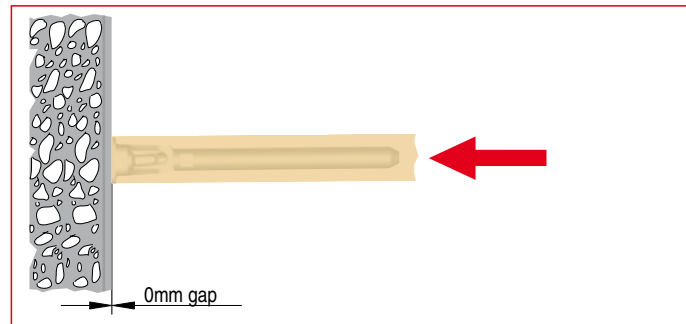

PUSH THE SHELF AGAINST THE WALL UNTIL THE END

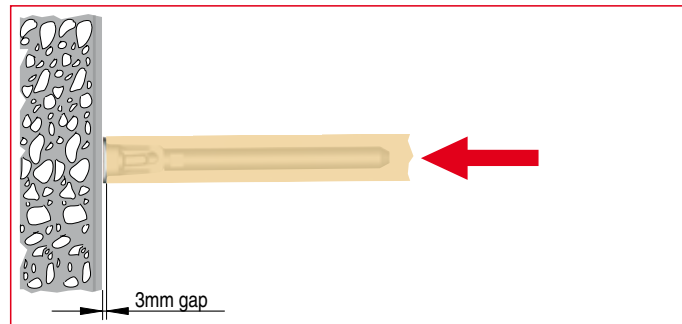

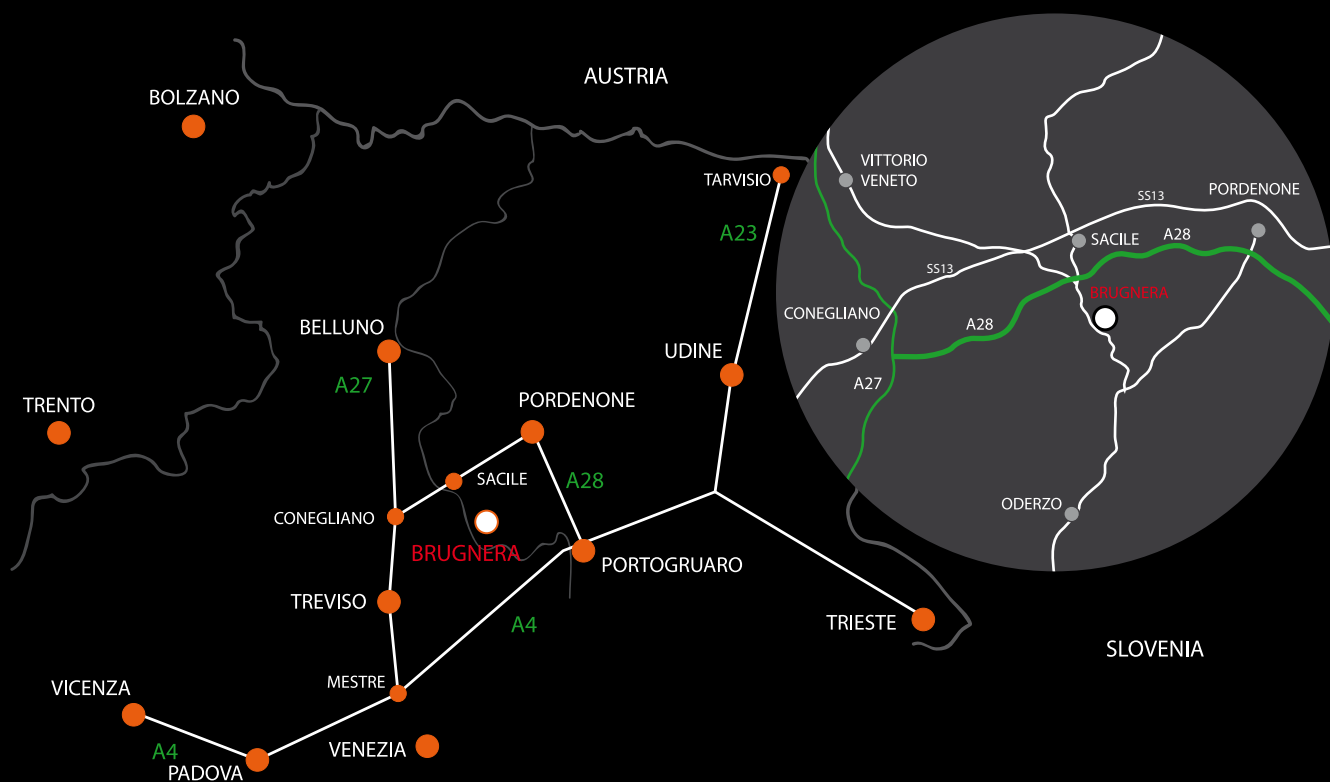

**ITALIANA FERRAMENTA**

Via Taglio n° 87 I - 33070 Maron di Brugnera (PN) Tel. +39 0434 428211 Fax +39 0434 428242 [www.italianaferramenta.com](http://www.italianaferramenta.com) [info@italianaferramenta.it](mailto:info@italianaferramenta.it)