



DOMUS Line®

ATOM





Luminaires for kitchens, living rooms and bedrooms



Architectural luminaires for bathrooms



Luminaires for classic furniture



Commercial lighting



Sensors and LED converters

DOMUS Line is an Italian company specialized in the **designing and production of lighting devices for the furniture industry**. Five brands put together the widest offer of lighting systems and control devices of the furniture lighting sector. Ongoing **research, innovation, design, reliability and brand reputation** are the distinctive values of our company.

Based near Venice in the North-East of Italy, in a region with strong industrial traditions, DOMUS Line is known the world throughout for its pragmatic approach, creativity and technological expertise.

A selected sales network distributes DOMUS Line appliances in over 70 countries in all continents, from the Americas to Oceania, guaranteeing the client expertise and assistance. The company's international commitment is constantly driven by its presence at both regional and international industry fairs.

DOMUS Line offers a wide range of lighting equipment certified according to the CE, UL, CSA, EAC, RCM schemes that enable its industrial and business partners to easily import and export products in the five continents.

DOMUS Line has been **ISO 9001** certified for many years and has entrusted its periodic audits to one the world's most prestigious entities. The **ISO 14001** environmental certification guarantees the company's commitment to continuous improvement and respect for the environment. DOMUS Line also adopts the OHSAS18001 standard (Occupational Health and Safety Assessment Specification) ensuring compliance with the requirements for the Management Systems of Health and Safety at Work.

DOMUS Line is also compliant to the voluntary and independent evaluation procedure called **SMETA** (Sedex Member Ethical Audit) and implements rigorously the basic ethical principles (**ETI**) in the company, convinced that a healthy and serene working environment is one of factors of business success.

The established collaboration with designers made possible the discovery of innovative ways and solutions that integrate the functionality the best Italian creativity. Innovation, design and environmental sustainability are values that are part of our DNA and that are perfectly expressed by the products.



ATOM

DOMUS Line
design

LED diffused lighting appliance

Materials:

thermoplastic polymers

Finishes:

chrome plated, aluminium, satin nickel

Light source:

SMD EDGE LED

Installation:

recess or surface

Application type:

inside cabinet, under cabinet,
under shelf

ATOM OB



ATOM SP

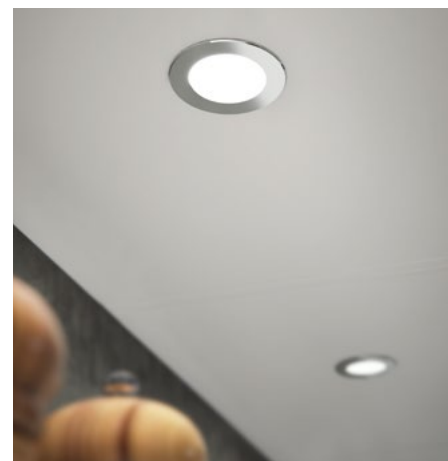

ATOM

TECHNICAL DATA

Power supply	24Vdc
Wattage	3W
Wiring	2000mm
Connector	Micro24

PHOTOMETRIC DATA

Colour appearance	natural white
Colour temperature	4000 K
Luminous flux	195 lm
Luminous efficiency	65 lm/W
CRI	Ra ≥ 80

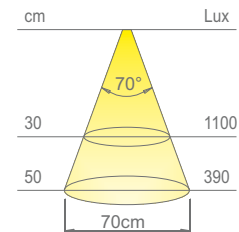
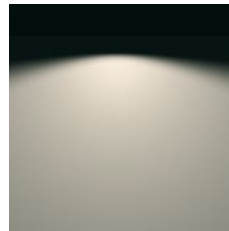

Colour appearance	warm white
Colour temperature	3000 K
Luminous flux	180 lm
Luminous efficiency	60 lm/W
CRI	Ra ≥ 80

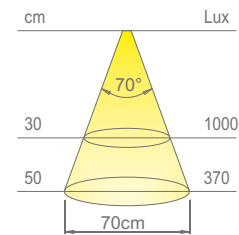
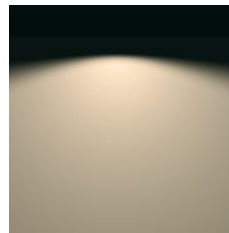

Colour appearance	super warm white
Colour temperature	2700 K
Luminous flux	180 lm
Luminous efficiency	60 lm/W
CRI	Ra ≥ 80

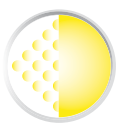
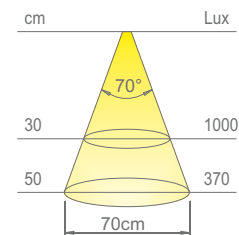
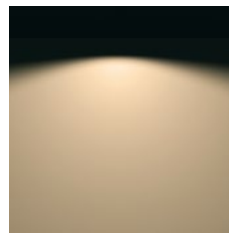
NO-DOT EFFECT LED technology

The device has a homogeneous and diffused light projection which is devoid of the dot effect typical of traditional LED spotlights. ATOM also integrates a special optic, which appears neutral and uniform even when the appliance is off.

Quick fixing system

ATOM is designed for **flush mounting with a Ø57mm hole** and an installation depth of only 8mm. The fixing system, with two lateral steel springs, is quick and does not require any tools. **ATOM SP** and **ATOM OB** are easily surface-mounted with the two spacers supplied.

MODELS



ATOM

ATOM is a LED diffused lighting appliance designed for flush mounting with a Ø57mm hole and an installation depth of only 8mm. Can be installed in wooden panels with both through and blind hole. The fixing system, with two lateral steel springs, is quick and does not require any tools.

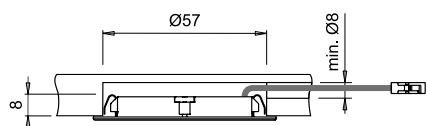

ATOM SP

ATOM SP is designed for surface installation without the need for planned and complex holes in the furniture. Assembly is achieved by simply mounting the spacer with the two supplied screws, to which the spotlight is then fixed by pressing lightly.

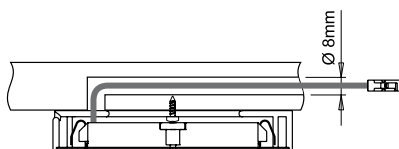

ATOM OB

ATOM OB has a particular inclined shape at 20° and is easily installed on the surface flush with the vertical wall, allowing the cable of the appliance to be easily concealed behind the cabinet.

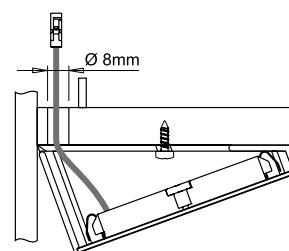

FINISHES



chrome plated (code 09)



aluminium (code 10)



satin nickel (code 17)

CODES AND DRAWINGS

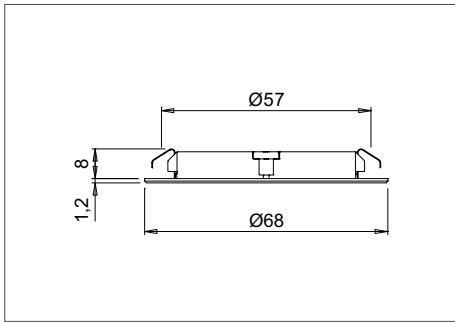

24Vdc



ATOM



Code	Model	Watt & Volt
12619_ _ _ **	recess	3W @ 24Vdc

CONVERTER NOT INCLUDED. TO BE ORDERED SEPARATELY.

ATOM set



Code	Model	Watt & Volt
22467_ _ _ **	3X recess set	9W @ 24Vdc
22468_ _ _ **	5X recess set	15W @ 24Vdc

CONVERTER INCLUDED.

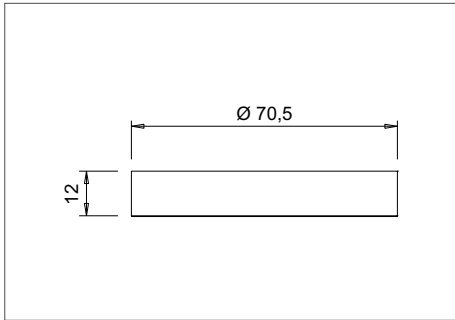

24Vdc



ATOM SP



Code	Model	Watt & Volt
12620_ _ _ **	surface	3W @ 24Vdc

CONVERTER NOT INCLUDED. TO BE ORDERED SEPARATELY.

ATOM SP set



Code	Model	Watt & Volt
22469_ _ _ **	3X surface set	9W @ 24Vdc
22470_ _ _ **	5X surface set	15W @ 24Vdc

CONVERTER INCLUDED.

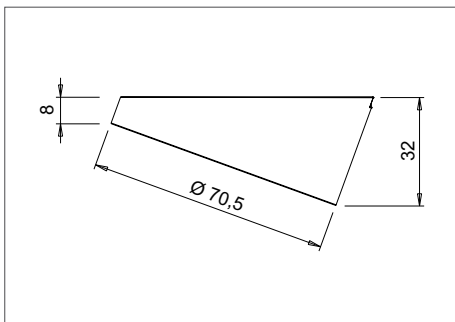

24Vdc



ATOM OB



Code	Model	Watt & Volt
12621_ _ _ **	surface	3W @ 24Vdc

CONVERTER NOT INCLUDED. TO BE ORDERED SEPARATELY.

ATOM OB set



Code	Model	Watt & Volt
22471_ _ _ **	3X surface set	9W @ 24Vdc
22472_ _ _ **	5X surface set	15W @ 24Vdc

CONVERTER INCLUDED.

* Please add the colour finish

09	chrome plated
10	aluminium
17	satin nickel

** Please add the light colour

N	natural white
B	warm white
B1	super warm white

* Example: 1261917N _ ATOM satin nickel natural white



CALL ME FW 2.0
wireless dimmable switch



Code	Input	Output	Load	Finish
1750801	12 - 24Vdc	12 - 24Vdc	36 - 72W	white
1750810	12 - 24Vdc	12 - 24Vdc	36 - 72W	aluminium
1750819	12 - 24Vdc	12 - 24Vdc	36 - 72W	steel



How CALL ME FW works

Switching on and switching off take place simply by pressing the remote control key of CALL FW. With an extended touch, it is possible to adjust the light intensity (dimmer function). A short flash of the device connected to CALL ME FW indicates having reached the maximum light. The light level will be stored until the next adjustment (level memory).

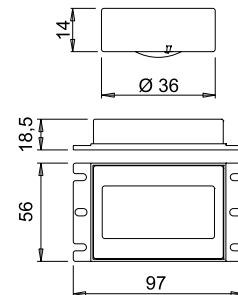

On request, two holders for recessed installation on wood panels are available.

- 2011601 white
- 2011610 aluminium
- 2011619 steel



white

aluminium

steel



TOUCH ME FW 2.0
TouchLed dimmable switch



Code	Input	Output	Load	Finish
1750701	12 - 24Vdc	12 - 24Vdc	30 - 60W	white
1750710	12 - 24Vdc	12 - 24Vdc	30 - 60W	aluminium



How TOUCH ME FW works

The switching on and switching off of the devices connected to TOUCH ME FW takes place simply with a quick touch of the LED. With an extended touch it is possible to adjust the light intensity (dimmer function). A short flash of the device connected to TOUCH ME FW indicates having reached the maximum light. The light level will be stored until the next adjustment (level memory). TOUCH ME FW also integrates the "night-light" function which is activated only when the devices are switched off.

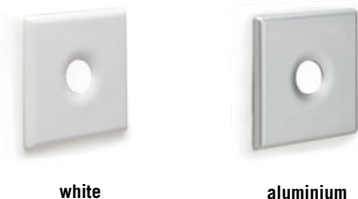
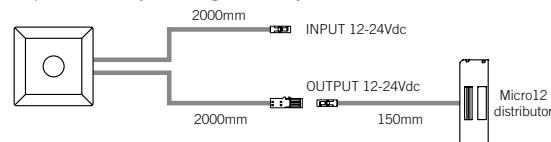
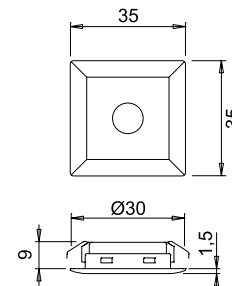

white

aluminium



DOT FW 2.0
Touch dimmable switch



Code	Input	Output	Load	Finish
1750905	12 - 24Vdc	12 - 24Vdc	36 - 72W	aluminium



How DOT FW works

Switching on and switching off of the devices connected to DOT FW takes place simply with a quick touch. With an extended touch it is possible to adjust the light intensity (dimmer function).

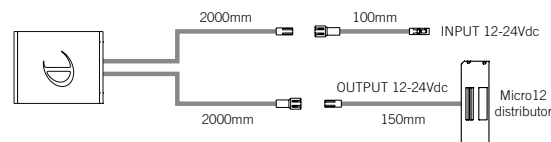
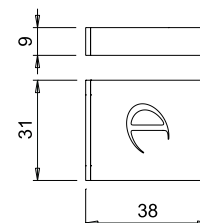



wood

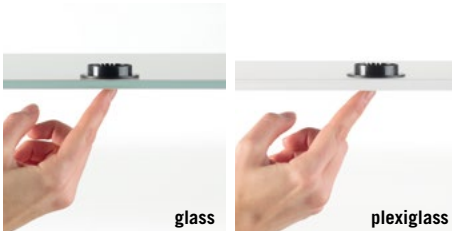

glass

plexiglass

CAPSENS FW 2.0

touch dimmable switch

CE IP44

Code	Input	Output	Load	Finish
1750603	12 - 24Vdc	12 - 24Vdc	30 - 60W	black

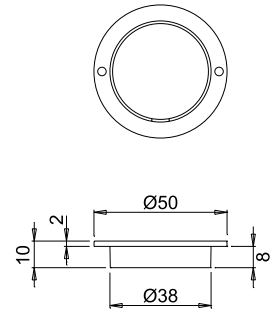
How CAPSENS FW works

Switching on and switching off takes place simply through hand contact with the surface beneath which has been applied CAPSENS FW. With an extended touch it is possible to adjust the light intensity (dimmer function). A brief flash with the device connected to CAPSENS FW indicates of having reached the maximum light. The light level will be stored until the next adjustment (level memory).

Material	H max
wood	30mm
plexiglass	20mm
glass	12mm

The data are indicative and the sensitivity of CAPSENS FW may increase or decrease in relation to the composition of the materials. CAPSENS FW cannot be installed on metal surfaces. For other materials (such as, for example, granite, marble and composite materials), it is recommended to carry out a preliminary test. The "activation" area is about 50 mm diameter.

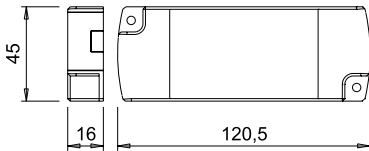
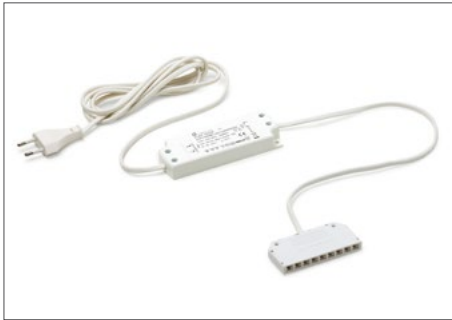
FLAT 15/24D

CE

Code	0846701
Input	220 - 240 Vac
Output	24Vdc
Load	15W
Input wiring	2000mm with europlug
Output wiring	500mm con with Micro24 distributor 10 connectors

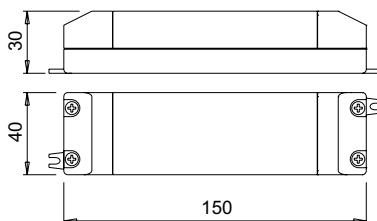
ST30/24D

CE

Code	0859101
Input	220 - 240 Vac
Output	24Vdc
Load	30W
Input wiring	2000mm with europlug
Output wiring	500mm con with Micro24 distributor 10 connectors



Appliance classification according to degree of electric shock protection



Class I luminaire

Luminaire in which protection against electric shock does not rely on basic insulation only, but which includes an additional safety precaution in such a way that means are provided for the connection of accessible conductive parts to the protective (earthing) conductor in the fixed wiring of the installation in such a way that accessible conductive parts cannot become live in the event of a failure of the basic insulation.



Class II luminaire

Luminaire in which protection against electric shock does not rely on basic insulation only, but in which additional safety precautions such as double insulation or reinforced insulation are provided, there being no provision for protective earthing or reliance upon installation conditions.



Class III luminaire

Luminaire in which protection against electric shock relies on supply at safety extra-low voltage (SELV) and in which voltages higher than those of SELV are not generated.

Appliance classification according to degree of protection against penetration by solids and liquids

IP44

Protection degree IP44

Protected against solid objects greater than 1mm. Protected against splashing water.

Other symbols



Independent lamp controlgear

Lamp controlgear consisting of one or more separate elements so designed that it can be mounted separately outside a luminaire, with protection according to the marking of the lamp controlgear and without any additional enclosure.

SELV

Safety Extra Low Voltage

ELV (voltage which does not exceed 50 V a.c. r.m.s. or 120 V ripple free d.c. between conductors, or between any conductor and earth voltage band I of IEC 60449) in a circuit which is insulated from the mains supply by an insulation not less than that between the primary and secondary circuits of a safety isolating transformer according to IEC 61558-2-6 or equivalent.



Indoor use

Equipment designed for indoor use only.

Norms and directives



CE

All the lighting appliances published in this catalog with the corresponding CE mark, have been designed and manufactured in compliance to the applicable European Directive (2014/30/EU, 2014/35/EU, 2011/65/EU). It guarantees the right of this product to be freely commercialized in all the states members of the European Union. DOMUS Line guarantee the compliance following the demand of the European-EN technical standard (and consequently international-IEC).



WEEE (Waste of electric and electronic equipment)

The product must be disposed of separately from household waste. The item should be handed for recycling centers according the local environmental rule for waste disposal. Appropriate separate collection of waste contributes to preventing negative effects on the environment and health and it encourages the reuse and/or recycling of materials. Illegal disposal entails the application of administrative sanctions provided by local law.

NOTE: All DOMUS Line luminaires are suitable for direct mounting on normally flammable surfaces such as that of the furniture.

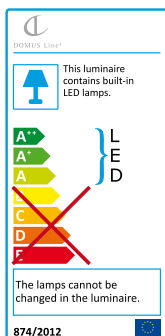

Devices with non-replaceable LED module

Energy efficiency class: A++, A+, A

EU Directive 2009/125/EC and relative Regulation : No. 1194/2012/UE, No. 1428/2015/UE.

Warranty

Each unit is fully guaranteed for a period of 24 months from the date of delivery. From the warranty are excluded all defects caused by force majeure (lightning, fire, etc.), as well as any damage caused by improper use of equipment. The products must be installed and/or used in accordance with the specifications and instructions given by DOMUS Line Srl. They must also be installed and/or used in compliance with the provisions governing the installation and/or use of electric material force in the country where the products are installed and/or used. To this end, the buyer expressly releases DOMUS Line Srl from any responsibility for improper use, failure to comply with safety standards, technical specifications and instructions for use. The products which do not meet the standards and/or specifications in force in the European Union, will only be provided to the buyer that in the order specifies that the destination country does not belong to the European Union and indicating to have exhausted all the controls on compatibility of safety standards in force in the country outside the EU for which they are intended. In the absence of other arrangements for testing of the equipment, the standards established by the CEI (Italian Electrotechnical Committee) are valid. The warranty is void without fail in the event of tampering with the equipment by persons or technicians not specifically authorized by DOMUS Line Srl. The warranty does not cover normal wear and tear or the consequences of improper installation, nor the failure and/or breaks caused by inexperience and/or neglect.

scan for general conditions of sale ►



Copyright

© 2017 DOMUS Line®

The brand and name DOMUS Line are registered trademarks. DOMUS Line owns brand names and known and widely used logos. The brand names and logos published in this catalogue are registered or in any case subject to the laws on unregistered brand names. All reproduction or distribution by any means: photocopies, internet, microfilm or other means, total or partial, of this catalogue is forbidden without the written permission of DOMUS Line.

Patents

The patented models, registered and published in this catalogue, are protected and counterfeiting will be prosecuted in accordance with the law.

Disclaimer

This document is distributed as “uncontrolled” and DOMUS Line reserves the right to change the characteristics of the products to meet any technical or commercial needs, without prior notice. DOMUS Line verified the data published in this document with the utmost attention. However, because of the variables that exist between the development process and the publication of the catalogue, DOMUS Line assumes no responsibility for errors, gaps in data, inaccuracies, and so on.



DOMUS Line®

DOMUS Line srl

Via Maestri del Lavoro, 1 I-33080 Porcia (PN) Italy

P. +39 0434 595911 F. +39 0434 923345

info@domusline.com

www.domusline.com